

THOM-PAK

Packing Tampers

Set of 3



FEATURES / BENEFITS

The 3-piece packing tamper set comes with three adjustable tamping tools that can be cut to fit a specific shaft size (small, medium, large).

TYPICAL APPLICATION

Installation of braided compression packing rings in pumps and valves. See reverse for installation instructions.

SPECIFICATIONS

Material: 92 durometer urethane

Packing tampers - radial cross section:

Small: 3/8", 5/16", 7/16"

Medium: 1/2", 9/16"

Large: 5/8", 3/4"

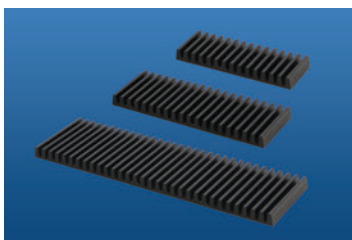

THOM-PAK comes in a 3-pc set.
To order, specify **Part #3114404**

	Length	Width	Thickness	Packing Sizes	Shaft Diameter
Small	7-1/2"	2-1/4"	0.30"	<ul style="list-style-type: none"> • 3/8" • 5/16" • 7/16" 	1-7/8" and up
Medium	10"	3"	0.45"	<ul style="list-style-type: none"> • 1/2" • 9/16" 	2-1/2" and up
Large	16"	4"	0.60"	<ul style="list-style-type: none"> • 5/8" • 3/4" 	4-1/4" and up

INSTALLATION - THOM-PAK PACKING TAMPERS

1. Measure sleeve/shaft diameter (D1) and stuffing box bore (D2).
2. Estimate the approximate packing ring length = $[(D1+D2) / 2] \times 3.1416$
3. To ensure proper cut, place the packing ring on a mandrel and butt cut or skive cut ends - installer preference.
4. Insert one packing ring at the bottom of the stuffing box. Lubricate each ring with Start UP Lube.
5. Insert the THOM-PAK tamper behind the first packing ring and tap evenly around with a hammer to seat the ring.
6. Remove the THOM-PAK tamper and insert the second packing ring. Stagger cut ends, minimum 90 degrees.
7. Repeat steps 5 and 6 for the remaining packing rings.
8. Install Gland follower - tighten follower and compress packing approximately 1/4" inch to seat the last ring. Back off gland follower to finger tight.
9. Start and allow packing and equipment to heat up, allow packing to leak at start up. Adjust slightly one flat at a time over the first few hours of operation to an acceptable leak rate.

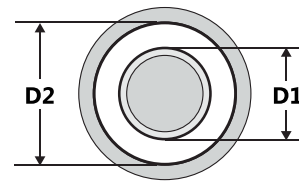
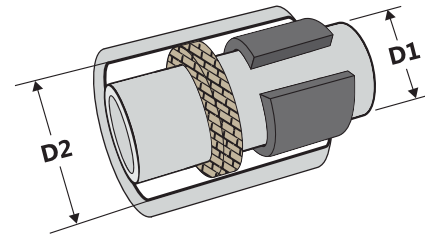

AUTHORIZED DISTRIBUTOR

Limitation of liability: actual performance may vary and is determined by factors unique to a given application. It is recommended that care be taken in the selection and application of materials for hazardous services and controlled testing be undertaken to determine suitability for a specific application. A.R. Thomson Group does not make or imply any warranty of suitability for a particular purpose and is not liable for any damages arising from the use of the information in this sheet.



Locations across Canada to serve you. For your nearest branch, please visit www.arthomson.com

Copyright © A.R. Thomson Group - All rights reserved. v1.1